

**FREIGEgeben ZUR FERTIGUNG**  
**RELEASED FOR PRODUCTION**

FEDERAL-MOGUL BREMSBELAG GMBH

DATUM/DATE: 13.01.2020

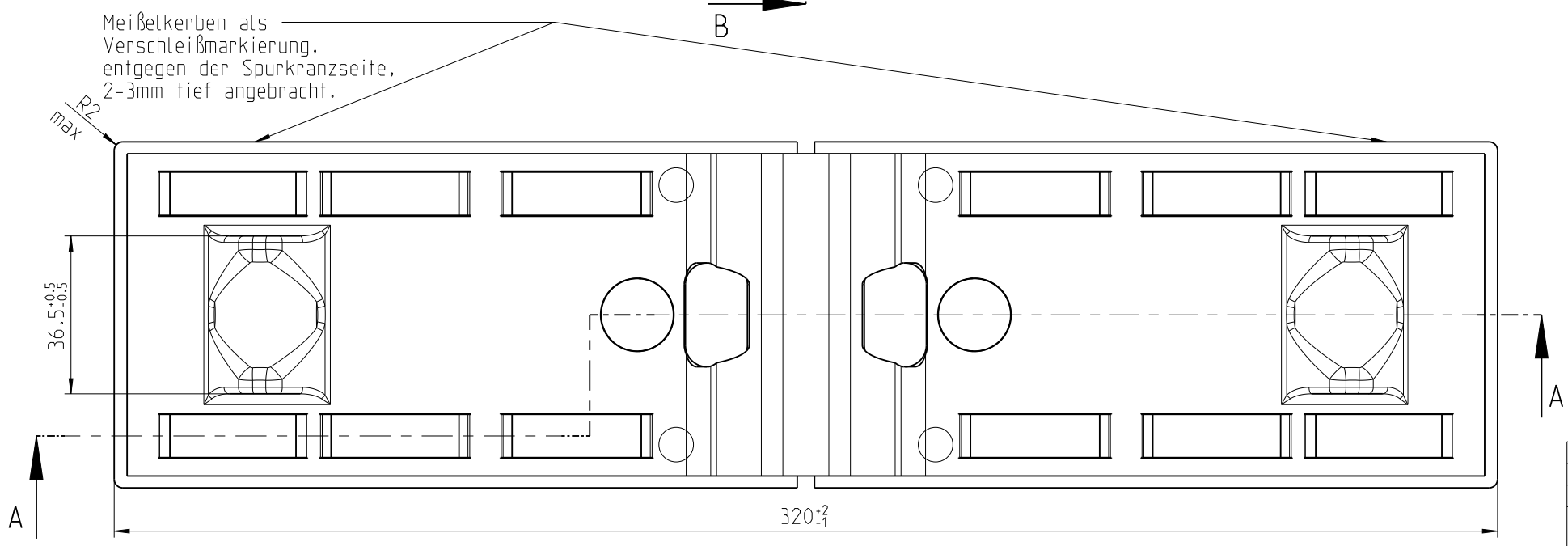
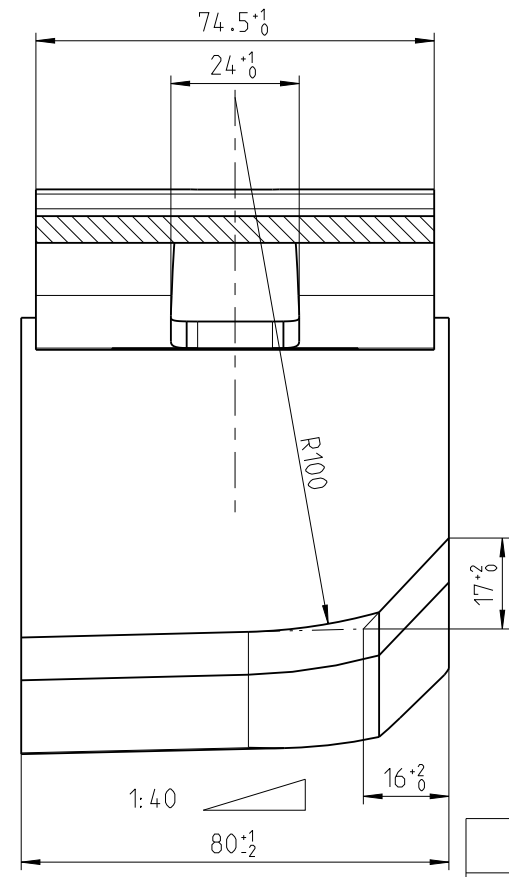
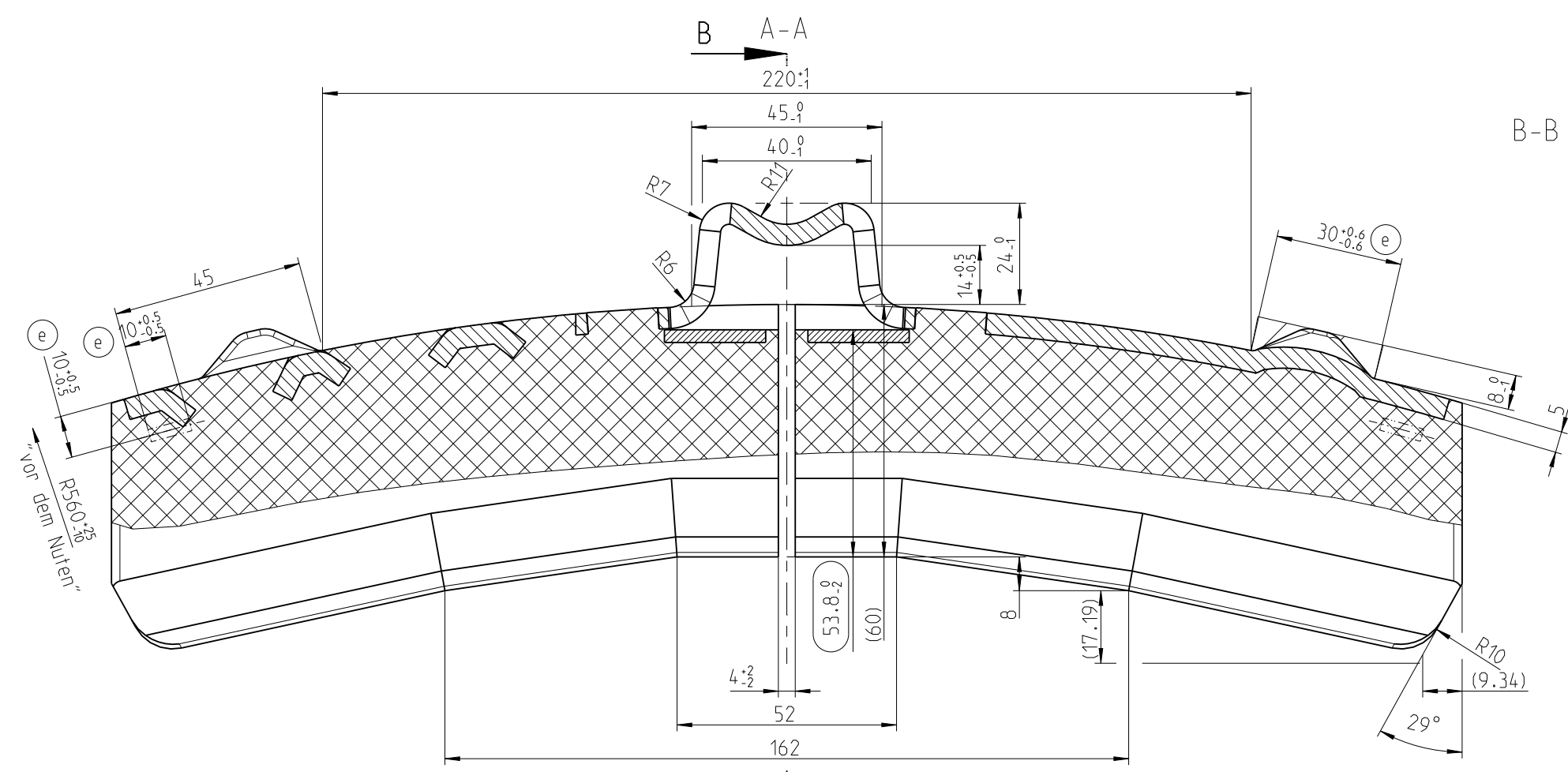

PART LIST

Item	Designation	Part/Dwg.-No.	Quantity
	BACKING PLATE	JP4-4045	
	optional		
1	BACKING PLATE	JP4-4025	1

Special Characteristics	ENG-GDM-SD-005	▲	⊙	△	⊗
Count					
Press-area	256 cm <sup>2</sup>				
Friction-surface	cm <sup>2</sup>	W/O Chamfer	cm <sup>2</sup>		
Pad volume	1399 cm <sup>3</sup>	W.Chamfer	cm <sup>3</sup>		
Type of brake					
Basic form					
WVA-number	55 395				
Customer Part-number					
F-M Part-number					

Revision	Changes	Date	Drawn
g	note 1 deleted	13.01.20	BK
f	text added	06.06.19	BK
e	BP changed: JP4-4025 was JP4-3923 and JP4-4045 was JP4-3121; 30±0.6 was 30: 10±0.5 was 10	03.07.14	Ber
d	3D model and drawing new	28.11.13	Ber
c	53.8 was 52.6	27.09.13	BG
b	SNCF No. added	17.06.07	SW
a	new created		

Customer / Application	Customer drawing-no & Rev.
	Rev.no: [.]

Drawn by	Köstner	Tolerancing acc.to	ISO 8015	General
AE approval by	Schütz			
AME approval by	M. B.			
Drawing state	released			
Issue date	20.11.06	Scale	Template	
Project-number		1:1	DIN A2	
Project-Name				

Name:	Bremsklotzsohle	
Drawing number:	J 2333	Revision
Origin:		g

Die aktuelle Version ist im Intranet Glfinde abgelegt. Dies ist eine Informationskopie, gedruckt am