

**FREIGEgeben ZUR FERTIGUNG**  
**RELEASED FOR PRODUCTION**  
 FEDERAL-MOGUL BREMSBELAG GMBH  
 DATUM/DATE: 13.01.2020

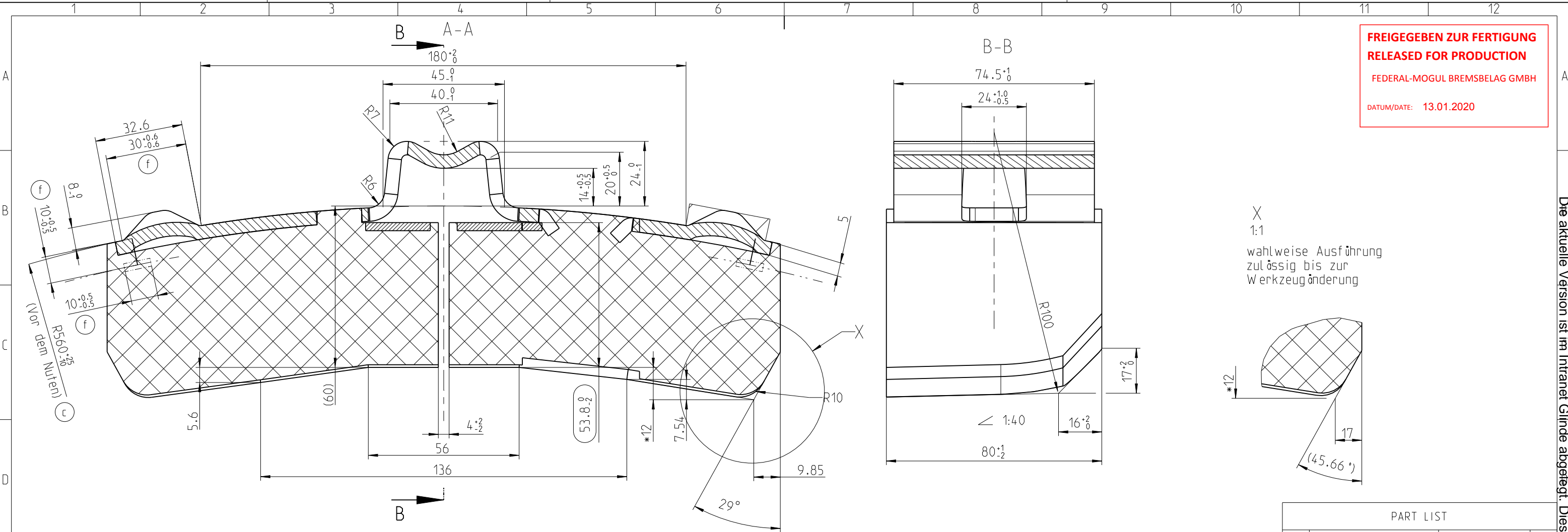

Meißelkerben als Verschleißmarkierung an beiden Enden, entgegen der Spurrandsseite, 2-3mm tief angebracht.

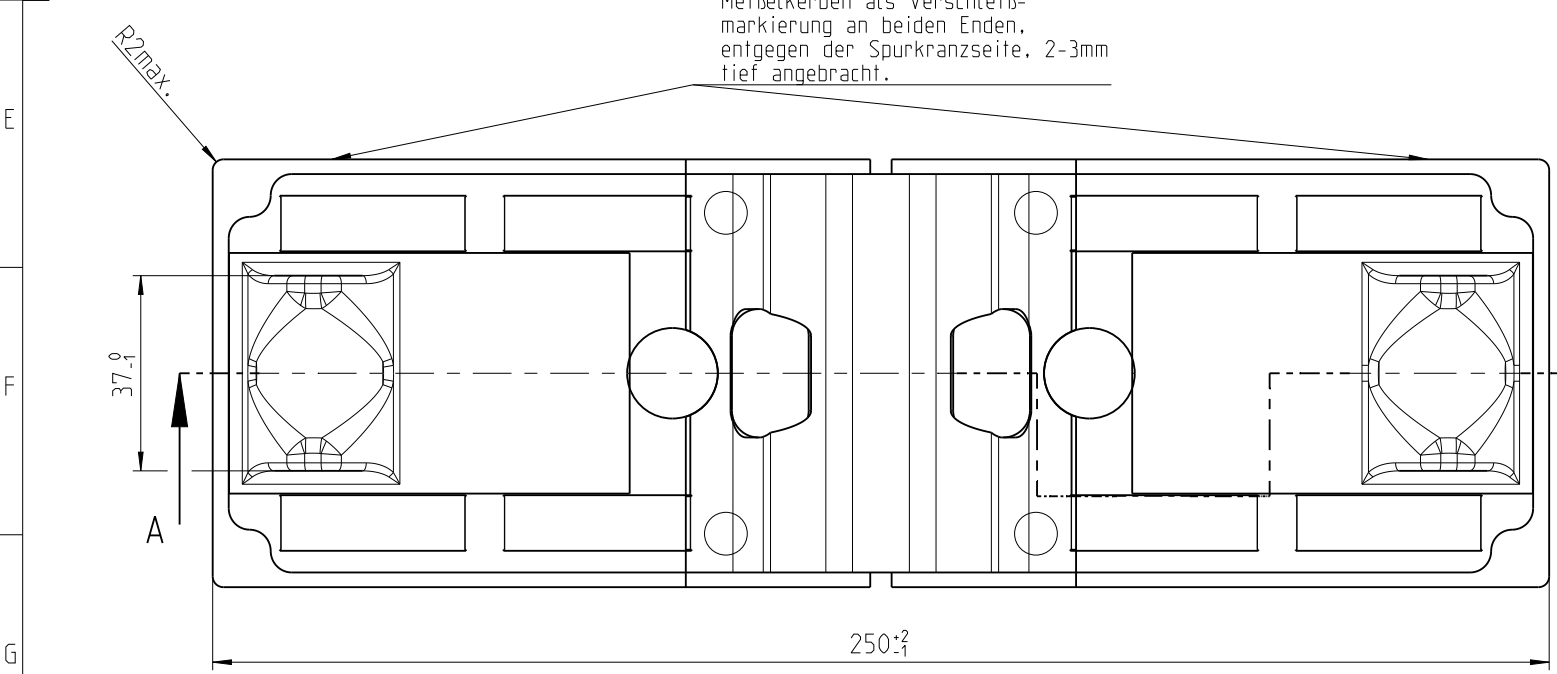

PART LIST			
Item	Designation	Part/Dwg.-No.	Quantity
	BACKING PLATE	JP4-4043	
	optional		
1	BACKING PLATE	JP4-4023	1

Special Characteristics	ENG-GDM-SD-005	Count	
Press-area	200 cm <sup>2</sup>		
Friction-surface	cm <sup>2</sup>	w/o Chamfer	cm <sup>2</sup>
Pad volume	1068 cm <sup>3</sup>	w. Chamfer	cm <sup>3</sup>
Type of brake			
Basic form			
WVA-number	55 394		
Customer Part-number			
F-M Part-number			
Customer / Application	Customer drawing-no & Rev.		
	für Raddurchmesser Ø920		
	Rev.no: [.]		

Revision	Changes	Date	Drawn
h	note 1 deleted	13.01.20	BK
g	text added	06.06.19	BK
f	30±0.6 was 30; 10±0.5 was 10	15.08.14	Ber
e	BP changed: JP4-4023 was JP4-3755 and JP4-4043 was JP4-3070	02.07.14	Ber
d	3D model and drawing new	28.11.13	Ber
c	inspection dimension and text added	15.09.08	SW
b	∠29° was 45.64; detail X added	18.04.08	Ta
a	new created		

Drawn by: Köstner  
 AE approval by: *Schmitt*  
 AME approval by: *M. Bauer*  
 Drawing state: released  
 Issue date: 14.12.05  
 Project-number: 1:1  
 Project-Name: **FEDERAL-MOGUL MOTORPARTS**  
 Tolerancing acc.to: ISO 8015  
 General tolerances: DIN ISO 2768-mK  
 Name: Bremsklotzsohle  
 Drawing number: J 2042  
 Revision: h

Die aktuelle Version ist im Intranet Glfinde abgelegt. Dies ist eine Informationskopie, gedruckt am